

House E, Garnich (LUX)

project **New construction of a single family house**

client **private**

services **WW+, Esch-sur-Alzette (LUX) / Trier (GER)**
architecture OAI services according to HOAI LPH 1-9

open space in cooperation with
GartenLandschaft Berg, Sinzig-Westum (GER)

civil eng. Simon Christiansen, Capellen (LUX)

photograph Linda Blatzek, Trier (GER)

photograph garden Marianne Majerus, London (UK)

dates and numbers

gfa **145 m²**

ufa **115 m²**

gv **1.700 m³**

total area **0,07 ha**

start of planning **09/2012**

realisation **03/2014 - 07/2015**

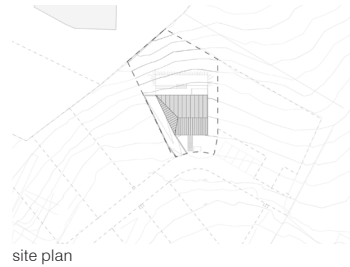

Integration into the surrounding environment

The shape of this single-family house is strongly influenced by its plot of land and associated building site, which spreads out in a trapeze form towards the valley. The topographical conditions of the southward sloping site guide the sensitive design of the outdoor facilities, with due consideration given to the existing protected trees. The result is a monolith-type building, supported by the monochrome colour scheme of the pitched roof, the colour of the façade and the materials used for the windows. The building's cubature fully exhausts the volume authorised by the building plan.

Room allocation

Access to the house is on the ground floor via a hallway, which incorporates the vertical access to the upper floor and links to the living areas. The living areas feature a generous and cohesive sequence of rooms, consisting of a dining area, a central kitchen with a cooking island and the living area, which extends in part across two levels and is visually separated by a two-sided glass fireplace and connected to the upper floor via a gallery. All the living areas are characterised by their strong references to the outdoor space. Generous windows towards the valley side provide an optimal influx of daylight, while an upstream footbridge and projecting platform provide outstanding views to the immediately adjoining terraced garden. The upper floor houses the bedrooms of the four-member family, an office connecting to the open space, a generous closed-off master bedroom area with a dressing room as well as the children's rooms, which extend under the sloping roof. The attic can be reached via a staircase in the office and is used as a playroom to complement the children's rooms. A special feature are the box windows, which protrude slightly from the façade and create sitting niches in the children's rooms. The interior design runs like a common thread throughout the entire house and features mostly built-in furniture, providing the family with ample storage space.

Energy concept

Energy is generated via a brine-water heat pump and a roof-integrated photovoltaic installation; heating is provided via underfloor heating while a heat recovery ventilation system provides controlled ventilation.

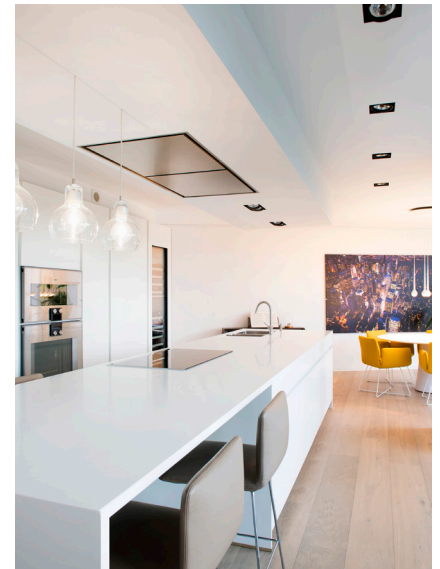

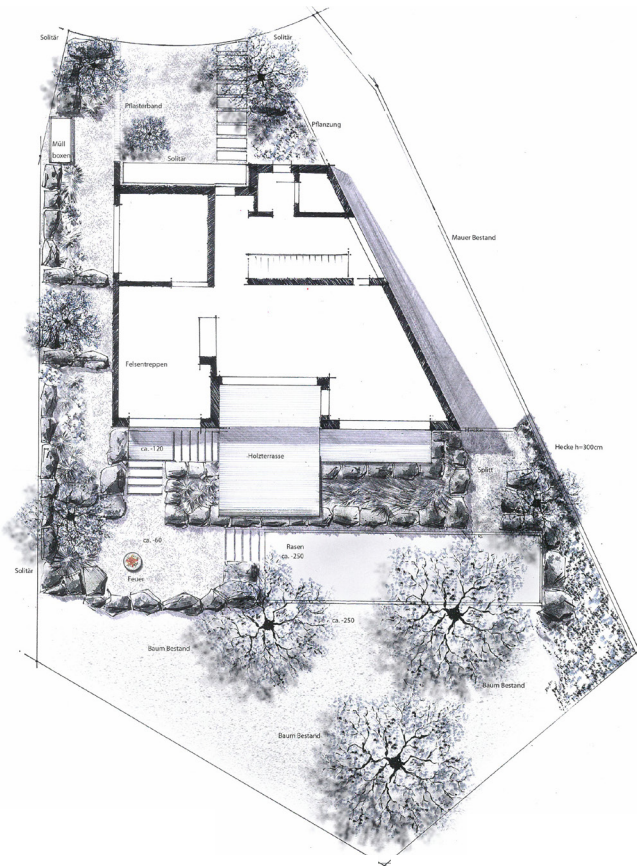

ground floor, open space planned by GartenLandschaft Berg



open space planned by Garten Landschaft Berg

